

ALL-IN-ONE
ALL-IN-ONE SOLAR
Instructions

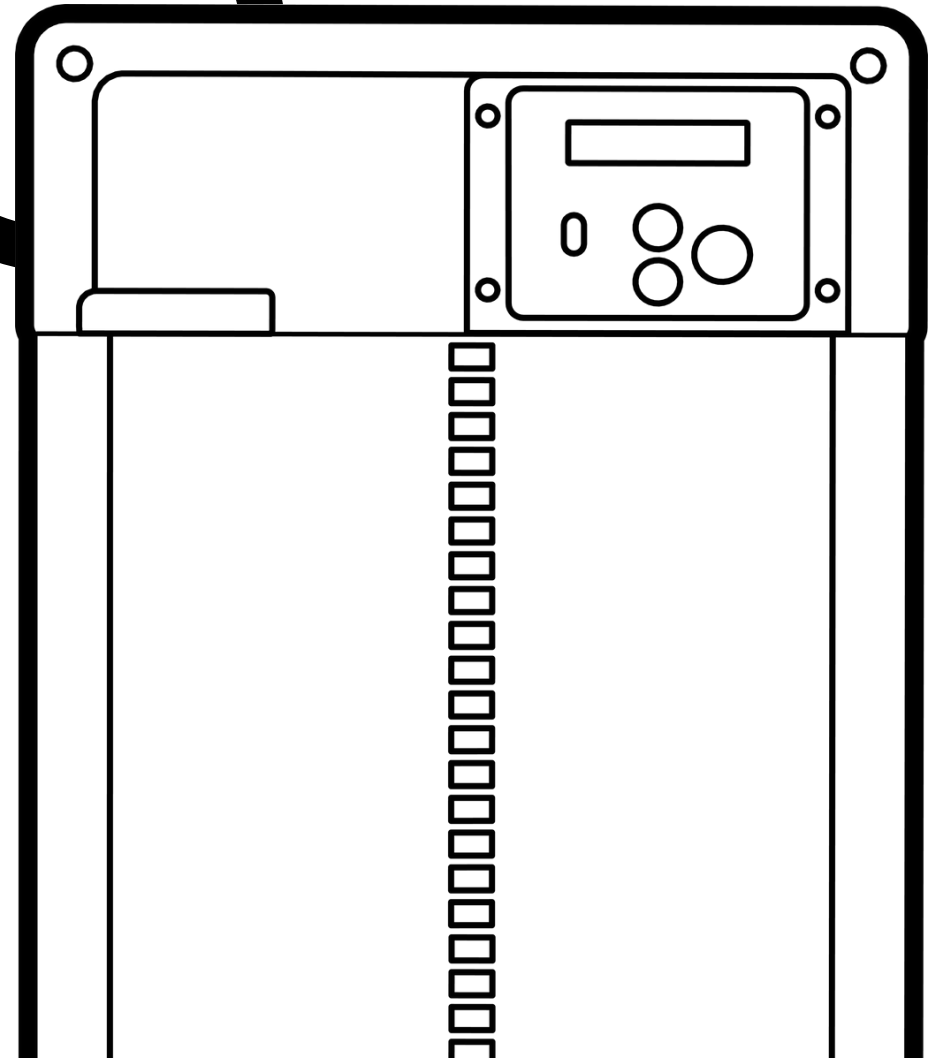

WHAT'S IN THE BOX?

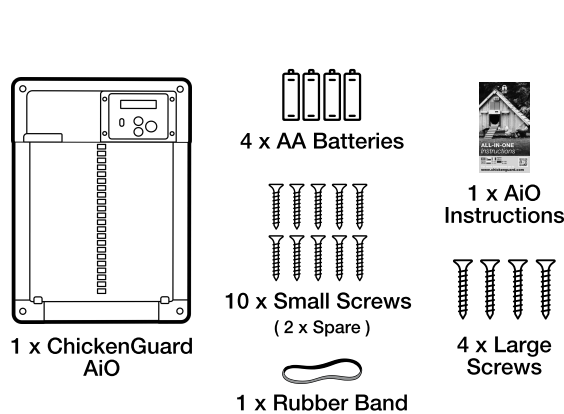

ALL-IN-ONE

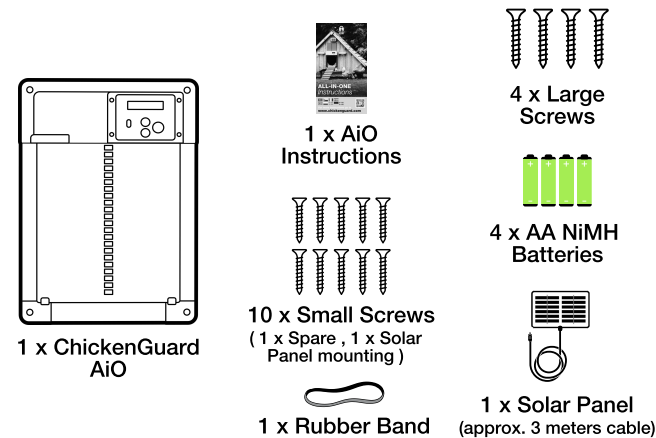

ALL-IN-ONE SOLAR

REGISTER YOUR WARRANTY

ChickenGuard's 3 year manufacturer warranty does not cover damage to the unit caused by external sources or insect infestations (e.g. red mite). It is important to clean and disinfect your coop regularly to safeguard your chicken's health & the ensure the smooth operation of your automatic door.

www.chickenguardwarranty.com



OPTION 1

Make a note of the serial number and go to www.chickenguardwarranty.com

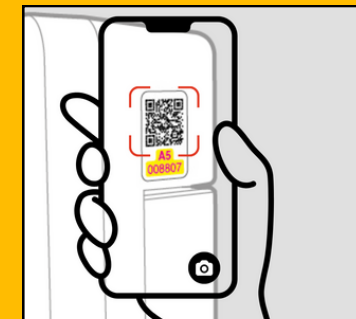

OPTION 2

Scan the QR code and activate your warranty.



1 How to install your ChickenGuard:



Step 1

Position the runners and footplate to make the frame as pictured. Secure using the 4 small screws as illustrated.

Do NOT use an electric drill!!

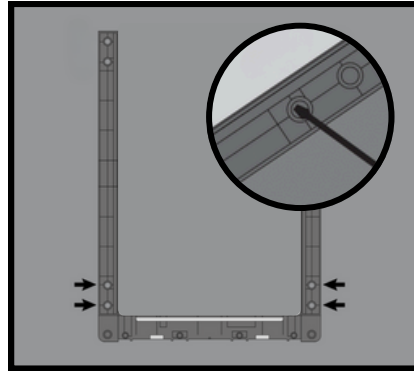

Step 2

Attach the rubber band as indicated and slide the door into the frame.

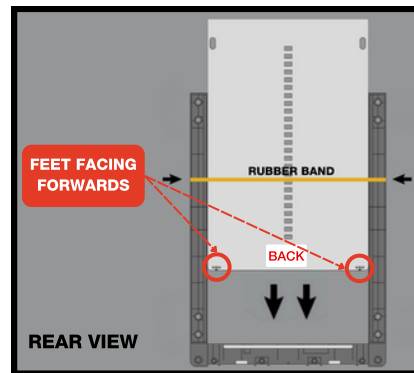

Step 3

Attach the door assembly onto the head unit using the 4 small screws as indicated opposite. Remove the rubber band.

Do NOT use an electric drill!!

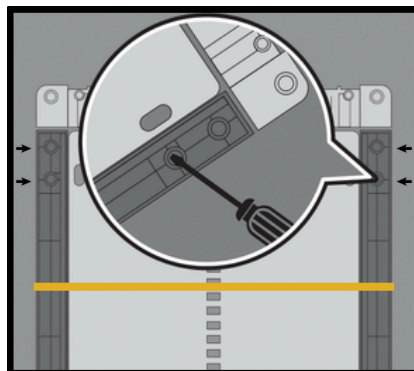

Step 4

Position the ChickenGuard and use a spirit level to ensure it is level. Use the 4 large screws provided, attach the unit to your coop.

Do NOT use an electric drill!!

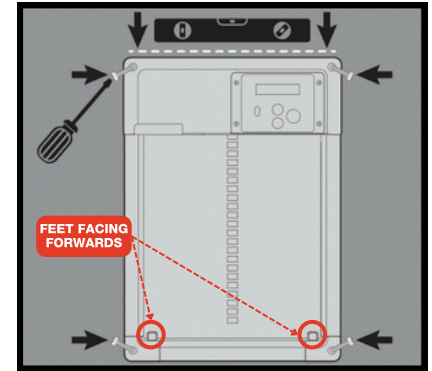

Step 5

Install the 4 batteries provided. The door will open after around 3 minutes if you have installed them during daylight hours. The ChickenGuard is now ready to use!

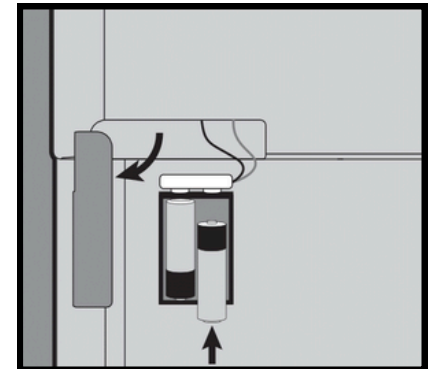

Do NOT use an electric drill!!

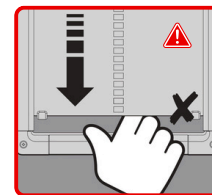

Please don't place your hand under the door when it is moving. Although there is an auto stop feature, the door will continue to close when it reaches the final 1/2" and there's a risk of pinching.

2 Solar Panel



If you don't have the Solar option go to the next page.



Step 1

Find the best location for your Solar Panel. It should be in a position pointing South. The 3-meter cable will give you flexibility if you have a big coop and want to place it on the roof.

DO NOT PULL ON CABLE. OVERSTRETCHING THE CABLE WILL DAMAGE IT.



Step 2

Fix the small screw (provided) onto your chosen location. This is used as the hook support for the panel. Don't over-tighten the screw.



Step 3

Make sure you've placed it in the desired location and hook the panel on to the screw.

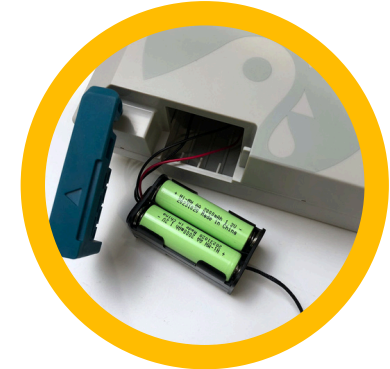

Step 4

If not already installed, place the 4x re-chargeable NiMH batteries into the battery holder.



Step 5

Remove the AiO Front Panel and connect the Solar Panel to the top socket.



**Let's now
Setup your
ChickenGuard!**

③ Initial Setup Guide:

Steps 1-2-3-4-5-6



1- Setup Wizard

When the screen is on, Press the MENU (⌂) button once to display the above. Press the MENU button a second time to get started. By pressing the UP or DOWN buttons you can navigate through the available menu options.

2- Language Press UP or Down

Press UP or DOWN to choose your language and press MENU (⌂) to save.

⬆️ = YES to continue

3- Clock 12/24hr. ⬆️ = 12hr ⬇️ = 24hr

Set the time
00:00

Set the Time Format using UP(12hr) or DOWN(24hr). Then, to set the time press UP or DOWN to set the hour and press MENU (⌂) to save. Now press UP or DOWN to set the minutes and press MENU (⌂) to save.

⬆️ = YES to continue

4- Door Calibration Step 2 of 4

Press the MENU (⌂) button to begin the automatic door calibration.

⬆️ = YES to continue

5- Open Settings Manual/Sensor/Timer

You have 3 options **Manual, Sensor, Timer**. Use the UP or DOWN button to select your Opening preference. Press MENU (⌂) to confirm your choice.

MANUAL / MANUEL / HANDMATIG

This option disables the automatic opening OR closing of the door.

SENSOR / CAPTEUR DE LUMINOSITÉ / LICHTSENSOR

This option is for automatic opening or closing of the door at dawn or dusk.

TIMER / MINUTERIE / TIMER

This option enables the opening or closing of the door at a user defined time. Use the UP or DOWN buttons to change the time, pressing MENU to confirm each unit.

6- Close Settings Manual/Sensor/Timer/LUX+

You have 4 options **Manual, Sensor, Timer and LUX+**. Use the UP or DOWN button to select your Opening preference. Press MENU (⌂) to confirm your choice.

LUX+

LUX+ (Dual Safety Closing) - This setting uses a combination of both the 'Light Sensor' and 'Timer' to close the door. The door opener will use the 'Light Sensor' as its' primary method to close, but, if it is not dark enough at your preset time, the door will then close. Only available for closing cycle.

Your ChickenGuard is ready to use!

Votre ChickenGuard est prêt à l'emploi !

Uw ChickenGuard is klaar voor gebruik!

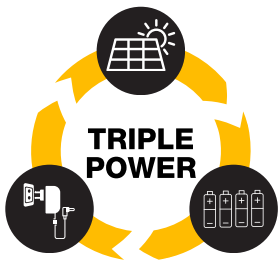

TRIPLE POWER



Triple Power gives you the choice to power your ChickenGuard to suit your setup. You can choose between using Solar, DC Power or Batteries. Here you can find how to move from Solar to Batteries Only and Solar to DC Power Only.

BATTERIES ONLY

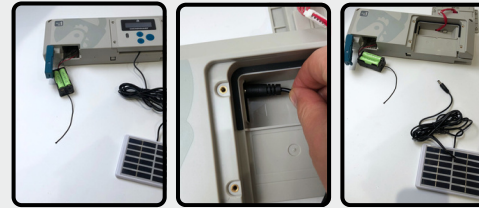

Step 1

Disconnect the solar panel.

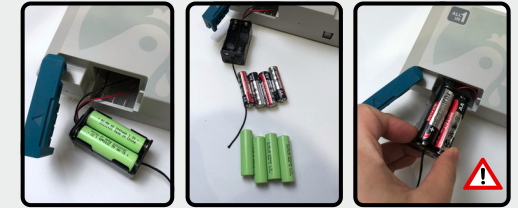

Step 2

Remove the NiMH batteries and place 4 x AA Alkaline/Lithium batteries. Done!

⚠ DO NOT USE SOLAR OR DC POWER WHEN USING ALKALINE/LITHIUM BATTERIES.

DC POWER ONLY

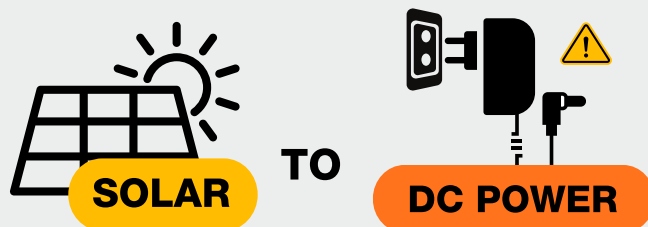

Step 1

Disconnect the solar panel. You can leave the NiMH batteries in.

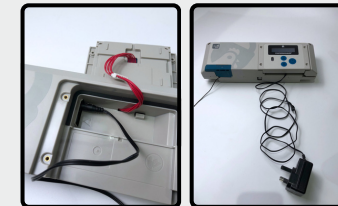

Step 2

Connect the DC Power. Done!



IMPORTANT INFORMATION:

The power supply needs to be 9 Volt DC with 1 Amp capability or greater. The socket is centre positive, 2.1mm x 5.5mm DC power plug. You can order it from our website www.chickenguard.com

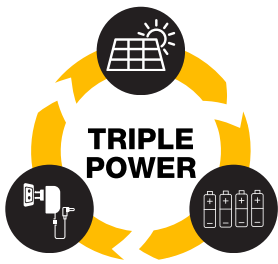

TRIPLE POWER



Triple Power gives you the choice to power your ChickenGuard to suit your setup. You can choose between using Solar, DC Power or Batteries. Here you can find how to move from Solar to Batteries Only and Solar to DC Power Only.

SOLAR

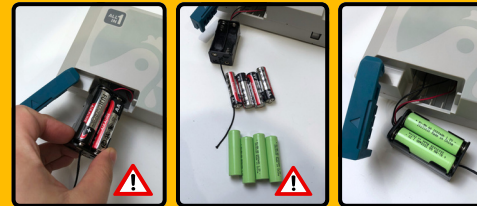

Step 1

Remove the Alkaline/Lithium batteries and replace with the re-chargeable NiMH batteries.

ONLY USE NiMH BATTERIES WHEN USING THE SOLAR CHARGING OPTION.



Step 2

Connect the solar panel. Done!

SOLAR

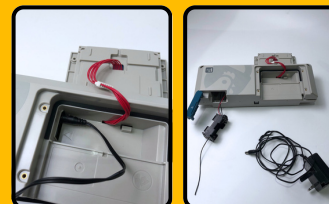

Step 1

Disconnect the DC Power from the unit.



Step 2

Place the NiMH batteries and connect the solar panel. Done!

This device can be used to a maximum altitude of 5000m.

The appliance is not to be used by persons (including children) with reduced physical, sensory or mental capabilities, or lack of experience and knowledge, unless they have been given supervision or instruction.

The appliance is not a toy: Children should be supervised at all times when coming into contact with the device.

WARNING

1. Install 4x AA Alkaline batteries. If using the Solar panel only use NiMH AA 2000mAh 1.2V batteries. If using mains power use a 9 Volt DC power adapter, 1Amp minimum.
2. When the batteries need changing, the red LED on the front panel will be permanently lit.
3. The red LED on the front panel will flash every 3 minutes when the door is CLOSED.
4. When replacing the batteries, the clock time will have to be updated.
5. Do not attempt to recharge Non-rechargeable batteries.
6. Remove and immediately recycle or dispose of used batteries according to local regulations and keep away from children. Do NOT dispose of batteries in household trash or incinerate.
7. Even used batteries may cause severe injury or death.
8. In case of ingestion or suspected ingestion of batteries, immediately contact a local poison control centre for treatment information.
9. Batteries are to be inserted with the correct polarity.
10. If the appliance is to be stored unused for a long period, the batteries should be removed.
11. The supply terminals are not to be short-circuited.
12. Do not force discharge, recharge, disassemble, store above 60°C/140°F or incinerate. Doing so may result in injury due to venting, leakage or explosion resulting in chemical burns.

EXTERNAL POWER

The AiO comes equipped with the ability to accept external DC Power. The socket is located behind the front panel on the main unit in the top left corner.

The power supply needs to be 9 Volt DC with 1 Amp capability or greater. The socket is centre positive, 2.1mm x 5.5mm DC power plug.

ChickenGuard®

Doodlehouses Limited

Unit 2 Station Yard, Wilbraham Rd, Cambridge, CB21 5ET, United Kingdom

Doodlehouses SL

Avenida Mar Mediterraneo, Primera Planta, Oficinas 15&16, Guadiaro, 11311, Cadiz, Spain

